







“ein unidentifiziertes politisches Objekt”
Jacques Delors

Its bold architecture, in such an urban setting, reflects the importance of its function, and the light which pervades it reflects its desire for transparency [...] Today, and after these historic developments to the image of Europe, [...] responding perfectly to the needs of a parliamentary democracy.

Jerzey Buzek, President of the European Parliament 2009 - 2012

“It took twenty years to completely transform a practically abandoned district and turn it into a workplace for the European Parliament”.

Alain Radelet, Executive Administrator of the Société Espace Leopold

“Projects are being developed to serve the needs not only of European institutions but of all people of Brussels. Europe’s presence brings substantial economic and cultural benefits to Brussels and Belgium. One element is still missing: a space reflecting the history of the European project, where visitors can see the development of European integration as one of history’s premier achievements toward peace, democracy and freedom.”

José Manuel Barroso, president of the European Commission

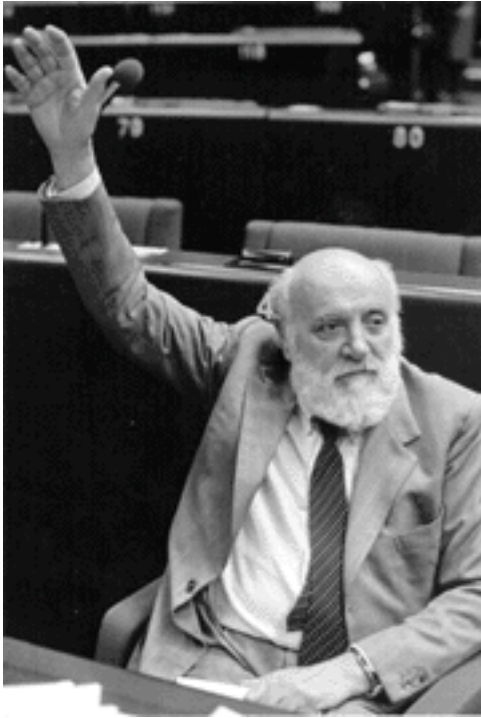

Konstitutionelle Methode:

- Krise des europäischen Nationalstaats --> Einzige Lösung europäische Föderation
- „revolutionäre Bewegung“ sollte eine Verfassung in Kraft setzen
- europäische Integration durch einen verfassunggebenden Akt
- Schaffung gemeinsamer supranationaler Organe zur Sicherung des Gemeininteresses
- Sah 1952 die Gründung der EGKS nicht hinreichend demokratisch legitimiert, nicht durch verfassungsgebende Versammlung sondern durch internationalen Vertrag gegründet
- vereinigtes Europa war für ihn zugleich Voraussetzung für die Befreiung der Arbeiterklasse und die Überwindung des Kapitalismus

„Die europäische Revolution muss sozialistisch sein, um unseren Bedürfnissen gerecht zu werden; sie muss sich für die Emanzipation der Arbeiterklasse und die Schaffung menschlicherer Lebensbedingungen einsetzen.“

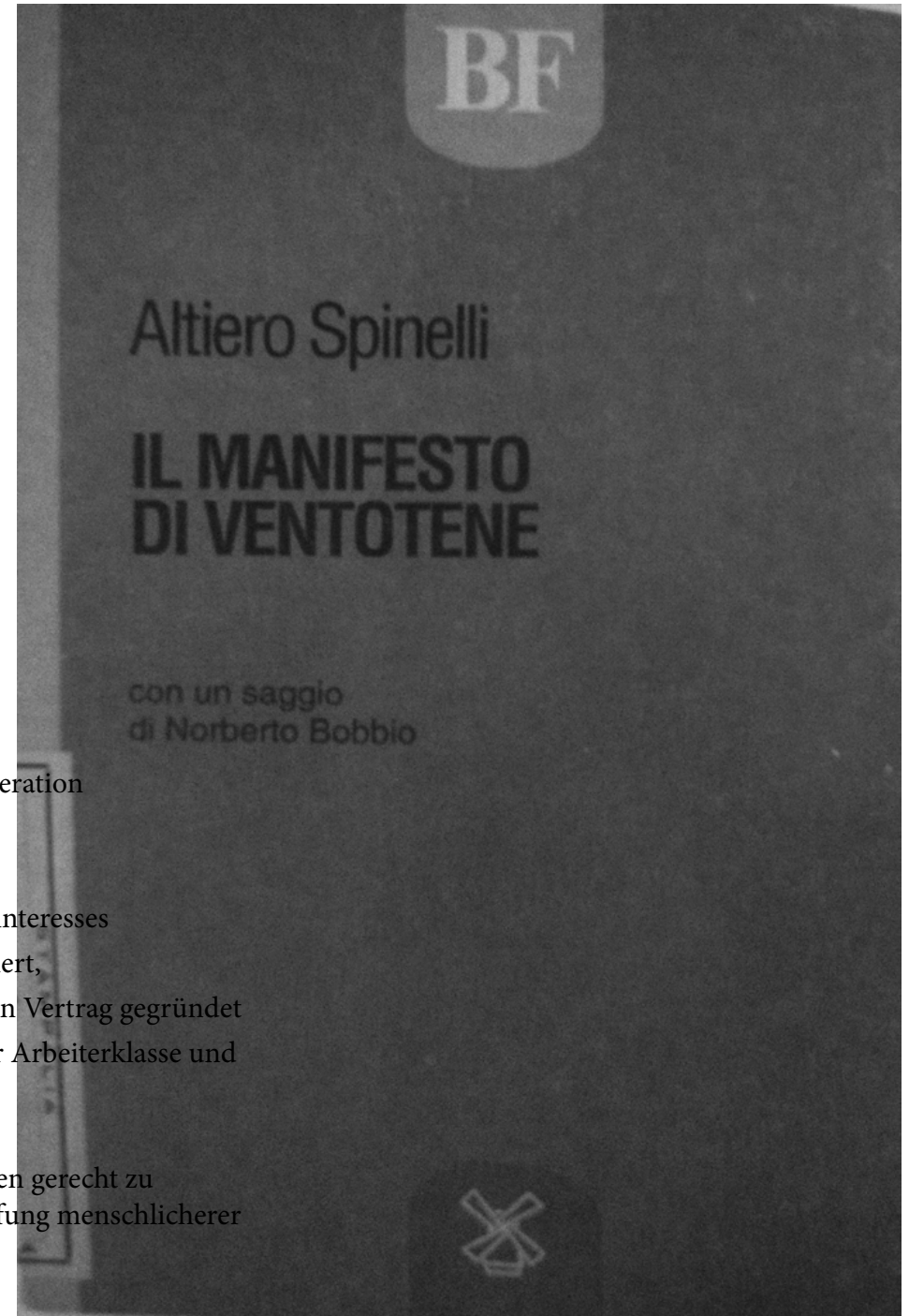

Monnet Methode:

- neofunktionalistische Integrationskonzept „der Dynamik in kleinen Schritten von nachhaltiger Bedeutung“
- Konkrete Solidarität der Tat
- Ökonomische Instrumente als Mittel der politischen Integration
- Im Konsens getroffene Eliten-Entscheidungen
- Etappe(n) auf dem Weg zu einer noch wenig ausgeprägten finalité



Jean Monnet

REPÈRES
POUR UNE MÉTHODE



Propos sur l'Europe
à faire

Fayard

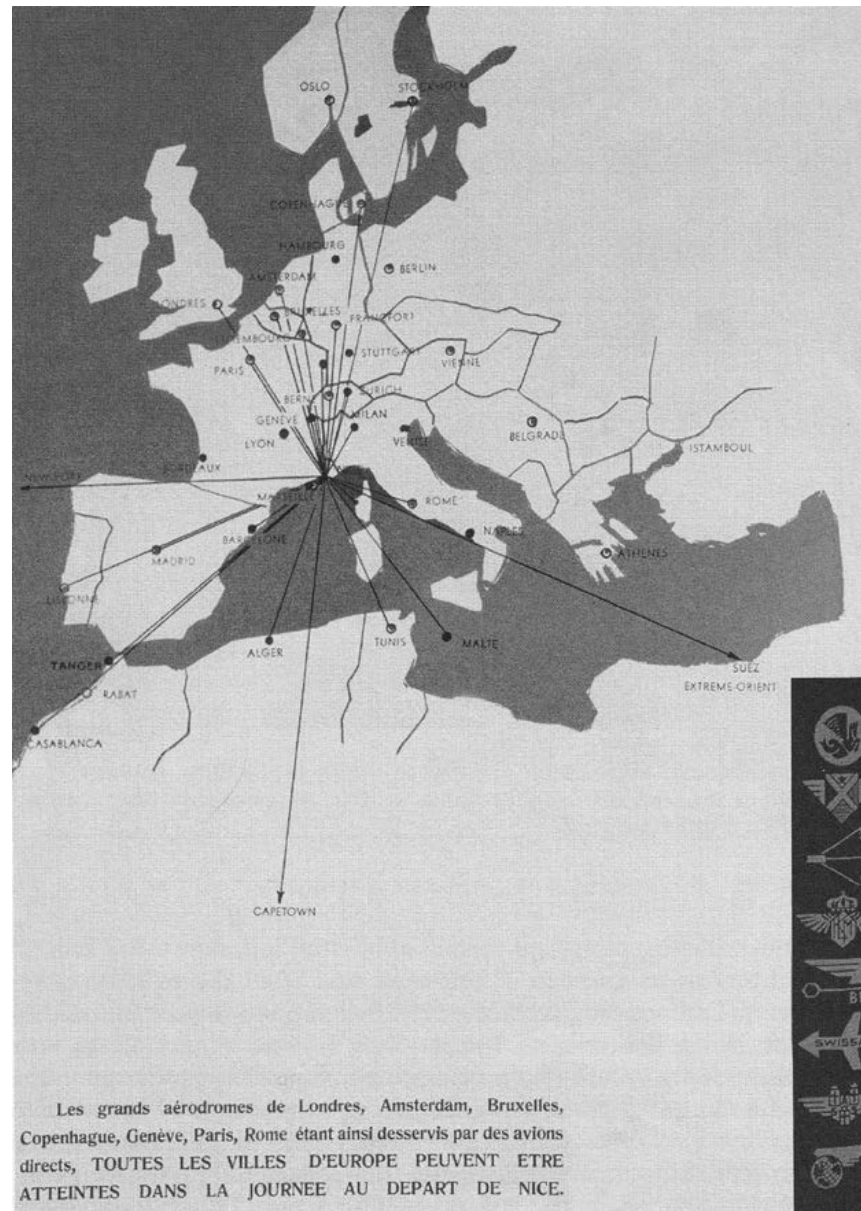

Nizza, 1957

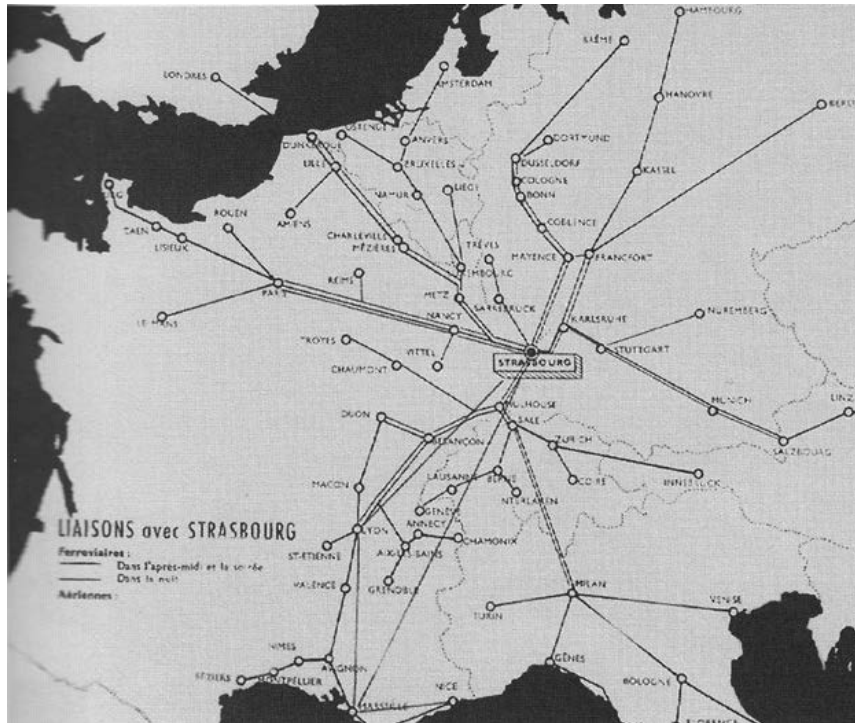

Strasbourg, 1957

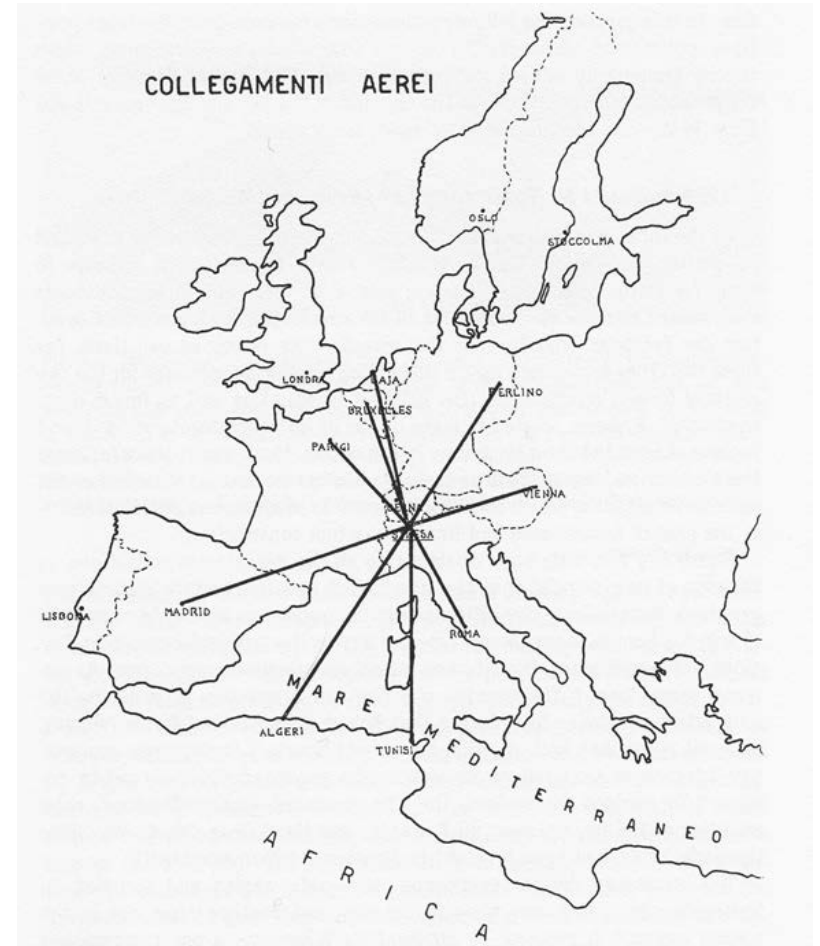

Stresa, 1957



La Jonction - 1955

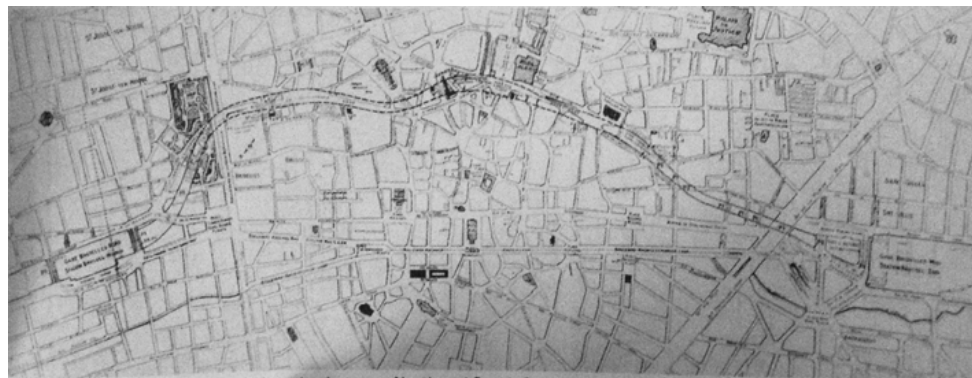

De n'importe où en
BELGIQUE

Vers n'importe où dans
LE MONDE

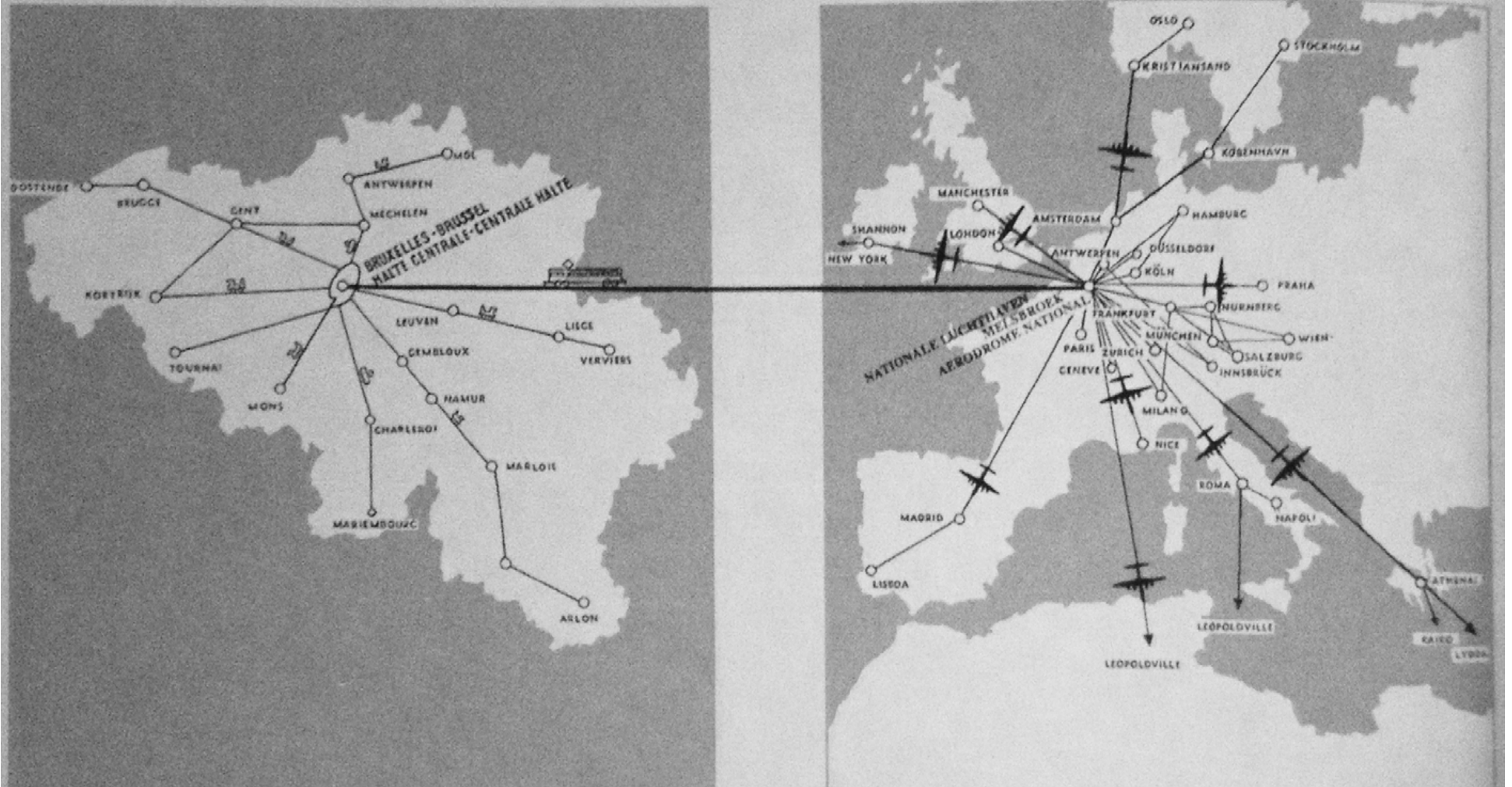

Bruxelles - 1957

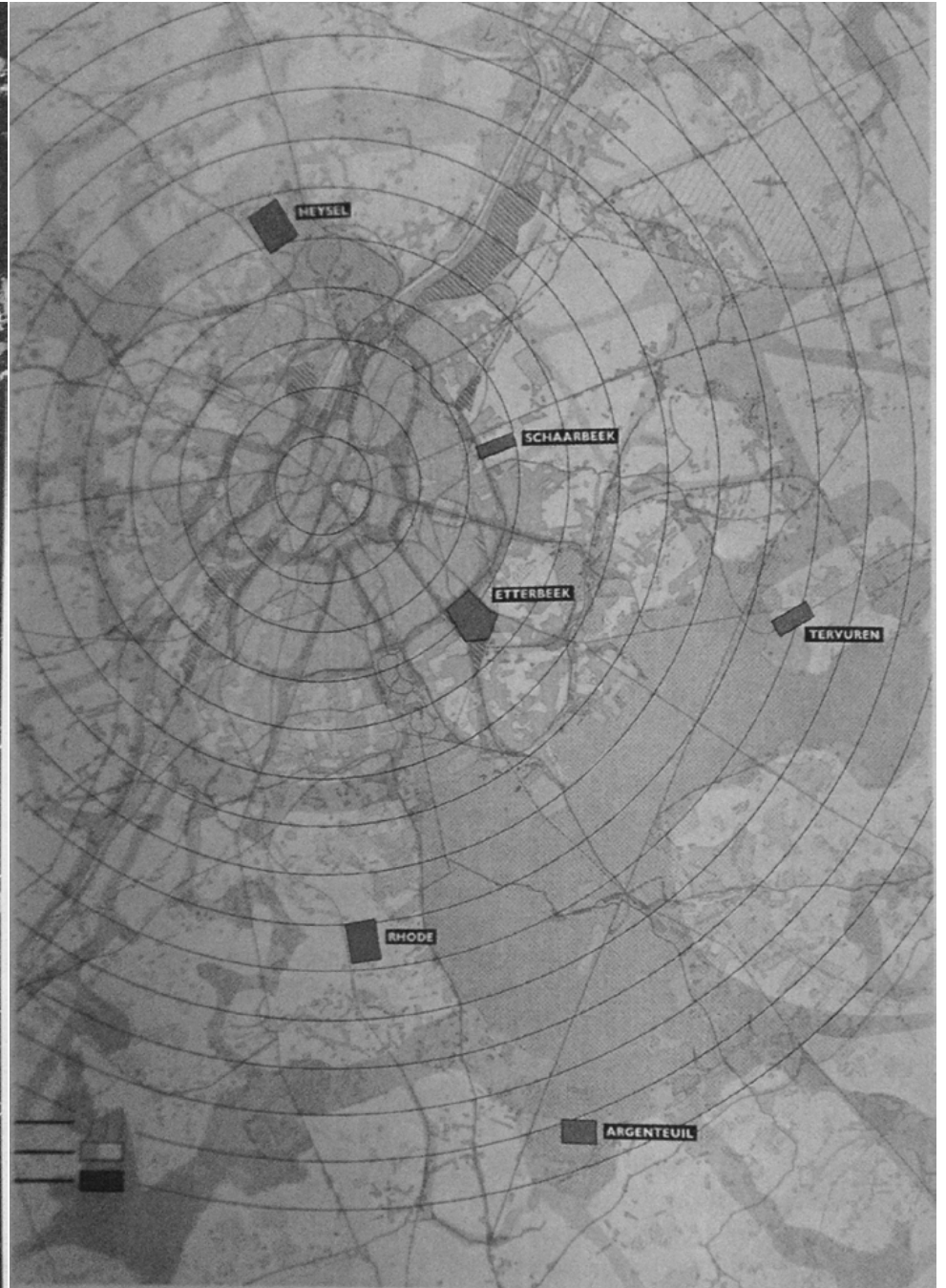

Plan Groupe Alpha - 1961



Bruxelles - 1950



1967



2013



Rue de la Loi - 1958

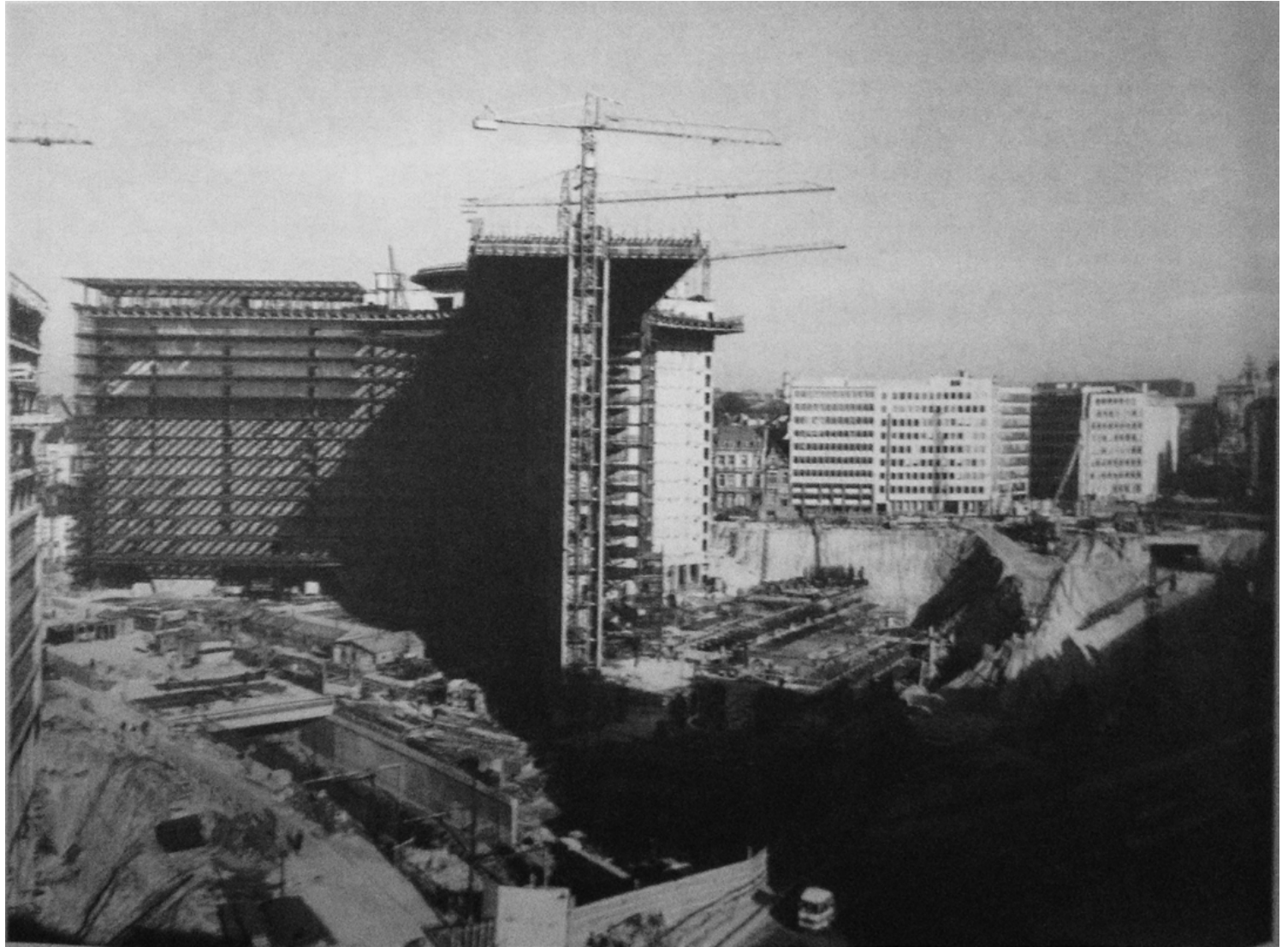

Europäische Kommission - 1965

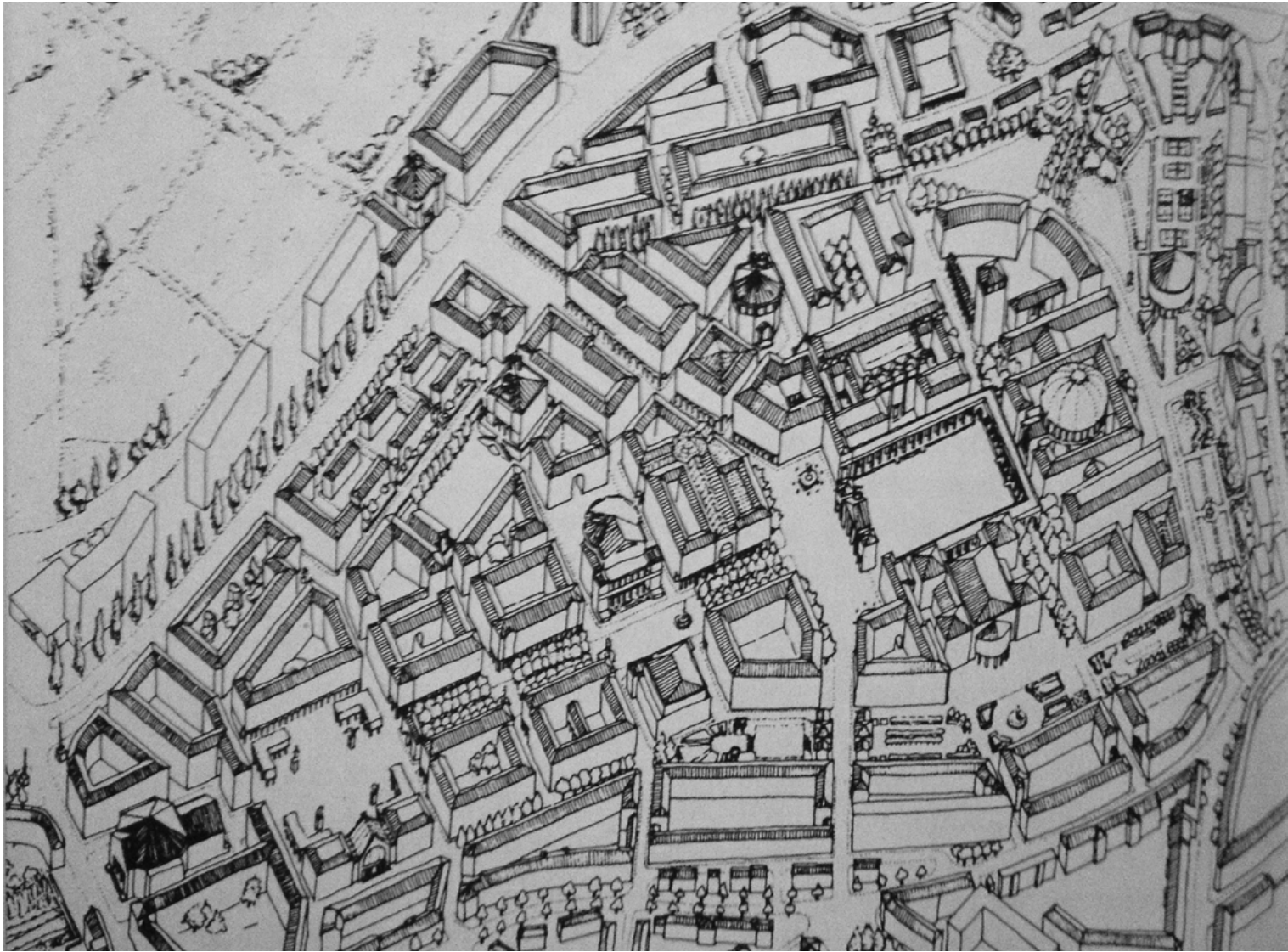

ARAU Proposal - 1965



Centre Borschette - 1981



Justus Lipsius Gebäude - 1987 - 1995



Société Espace Leopold
Mr. Detremmerie, President of the Société Espace Léopold;
Mr. Vanescote, Vice-President of the Société Espace Léopold;
King Baudouin
Architect A. Jacqmain
April 1993





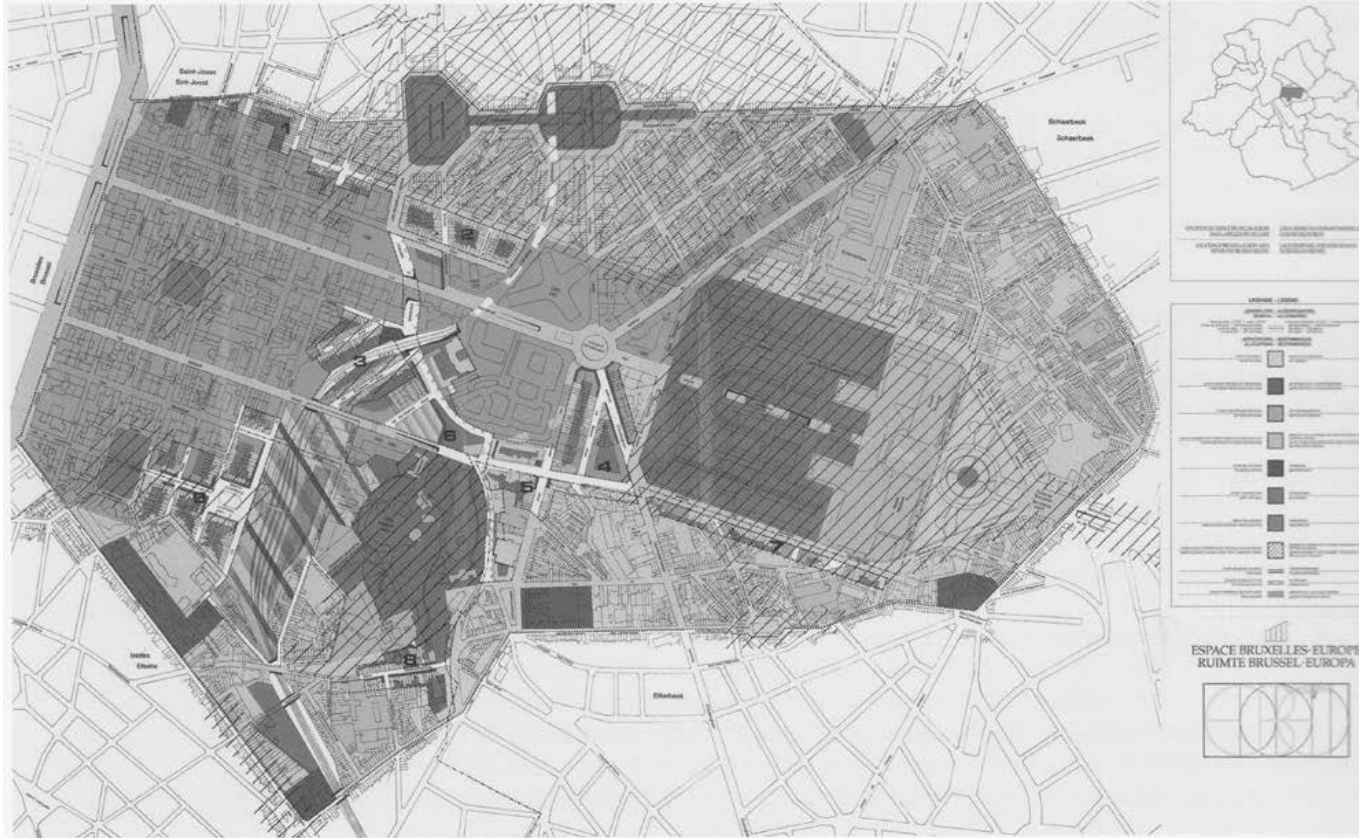

CERAU - l'Espace Bruxelles Europe - 1987



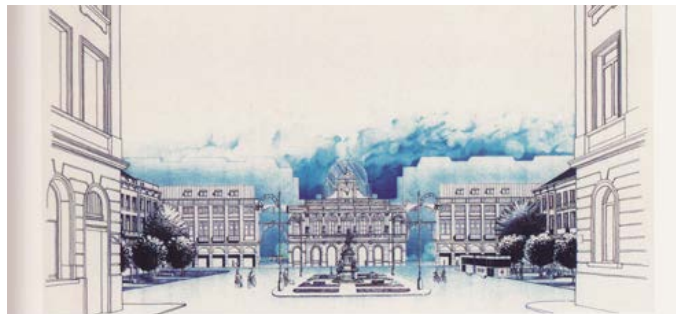
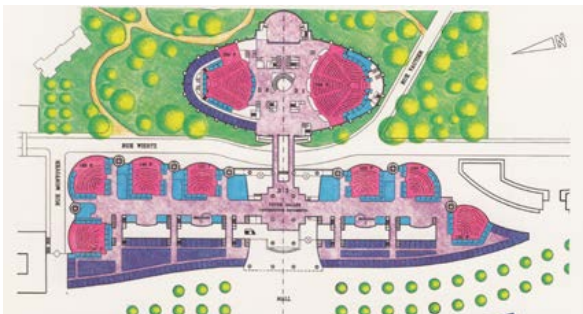
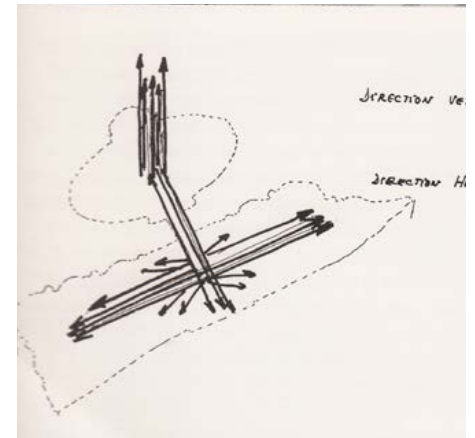
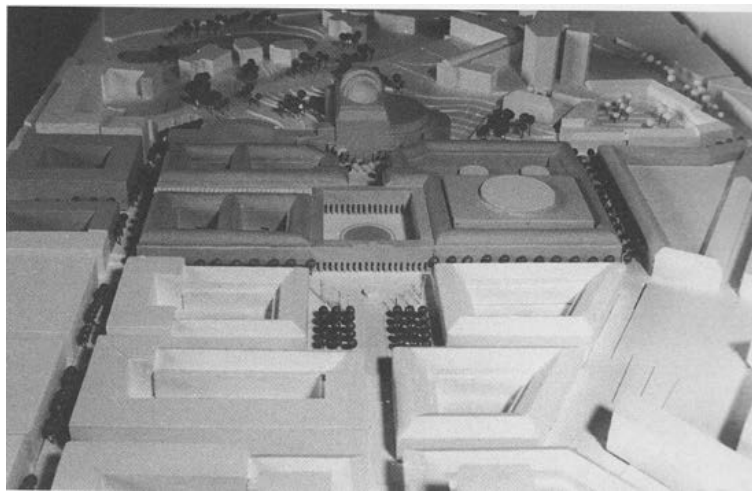
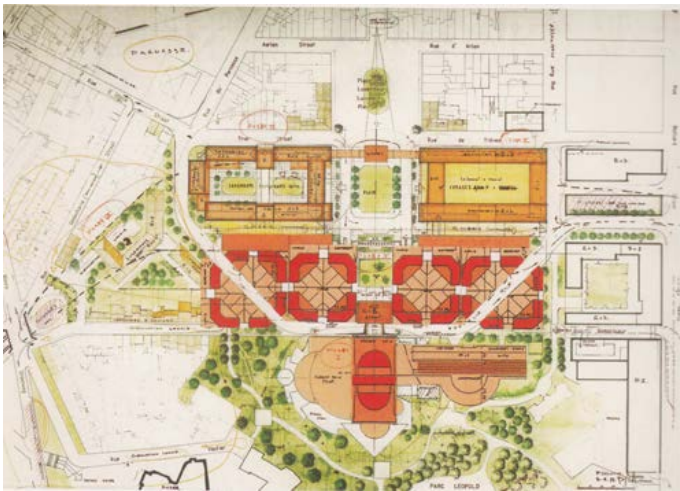
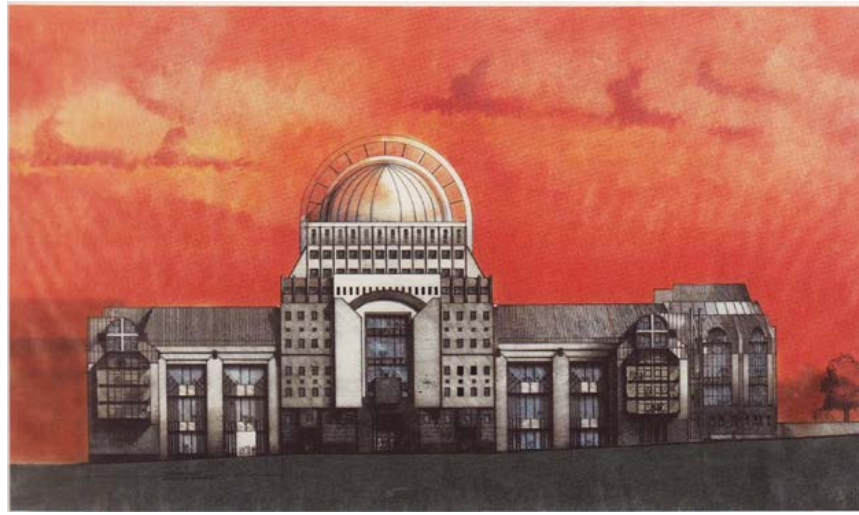



Gare Luxembourg 1993



8. Januar 1992 - Pachtvertrag für 27 Jahre

Messer Vankeirsbilk, Financial Engineer of the COB Bank, Albert Vanescote, Société Générale de Belgique; Hubert Detremmerie Charimann of COB Bank and SEL; Enrique Baron Crespo, President of the EP; Hans Peters MEP and President of the Real Estate Policy Group of the EP; Guy Delens, representative of the consortium of builders; Jacques Bellemans, Director of the COB Bank; Dick Toornstra, Director of the EP; Enrico Vinci, Secretary of the EP; four PIM-Group Members; Roger Glass, Head of Division at the EP; Guy Moentack, expert consultant on policy for the officers of the EP; Jean Feidt, General Director of the EP.

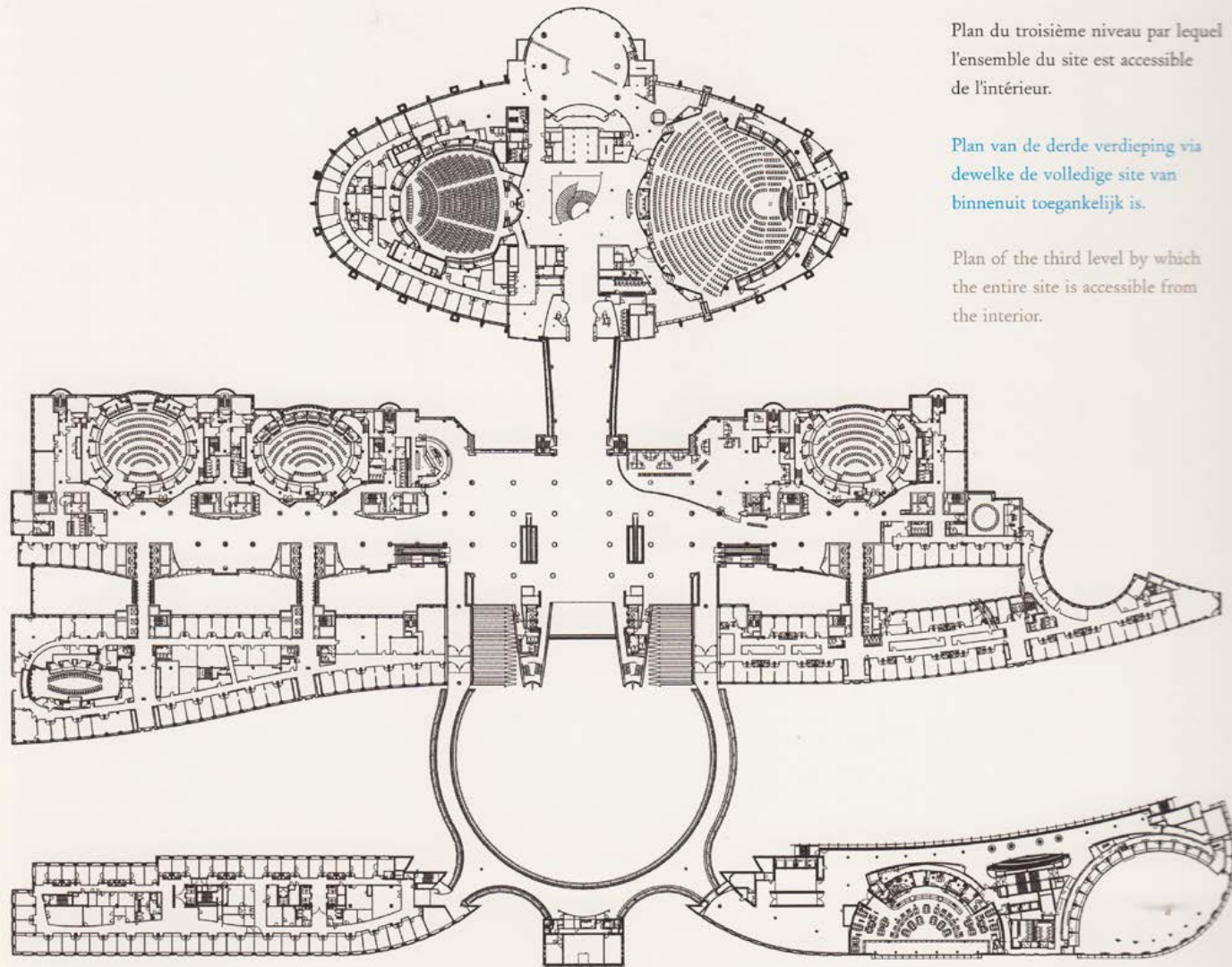

Plan du troisième niveau par lequel
l'ensemble du site est accessible
de l'intérieur.

Plan van de derde verdieping via
dewelke de volledige site van
binnenuit toegankelijk is.

Plan of the third level by which
the entire site is accessible from
the interior.

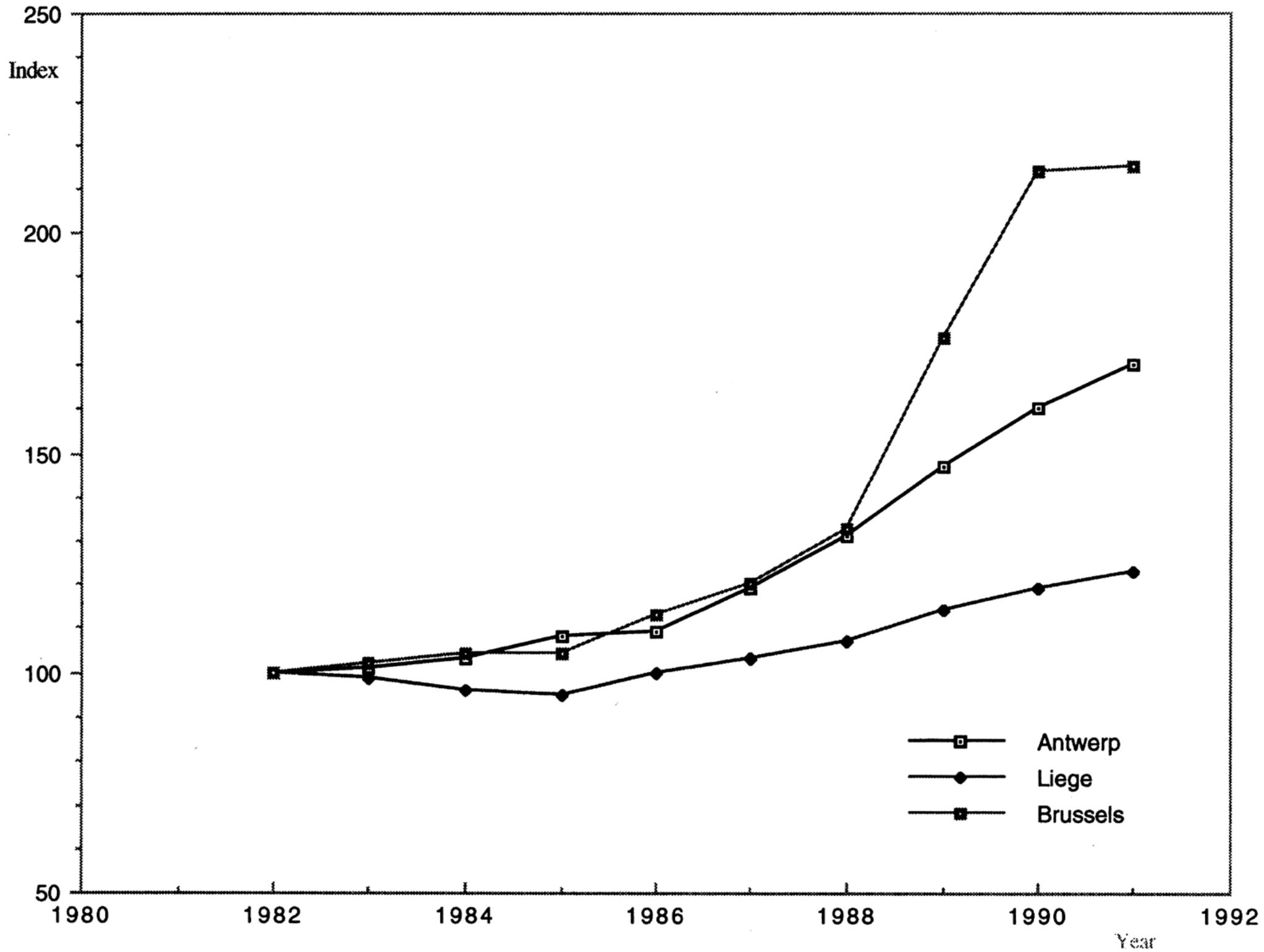



EU-Institutionen::

- a** EU-Kommission (Berlaymont)
- b** Rat der EU (Justus Lipsius)
- c** Europäisches Parlament
- d** GD Gesundheit und Verbraucher
- e** GD Binnenmarkt und Dienstleistungen
- f** GD Forschung und Innovation
- g** GD Handel
- h** Albert Borschette Centre

Die Lobbyakteure::

- 1** European Financial Services Roundtable
- 2** City of London
- 3** US Chamber of Commerce
- 4** BP
- 5** Shell
- 6** Aquafed
- 7** Lisbon Council
- 8** FIPRA
- 9** White & Case
- 10** IETA

- 11** AmCham EU
- 12** FoodDrinkEurope
- 13** FEFAC
- 14** European Training Institute
- 15** Daimler
- 16** BusinessEurope
- 17** European Services Forum
- 18** BASF
- 19** Gplus
- 20** ECIPE
- 21** Foratomb
- 22** Interel Cabinet Stewart

- 23** European Seed Association
- 24** Burson-Marsteller
- 25** Fleishman-Hillard
- 26** International Swaps and Derivatives Association
- 27** Edelman The Centre
- 28** Deutsche Bank
- 29** Bank of New York Mellon
- 30** APCO Worldwide
- 31** Hill & Knowlton
- 32** Europäischer Bankenverband

- 33** European Parliamentary Financial Services Forum
- 34** Concert Noble
- 35** Unilever
- 36** Cabinet DN
- 37** Bibliothèque Solvay
- 38** Bayerische Landesvertretung
- 39** Bertelsmann
- 40** Bastion Tower
- 41** Facebook
- 42** Corporate Europe Observatory

- EU-Institutionen
- Unternehmen
- Lobbyagenturen/ Public Affairs-Agenturen
- Verbände
- Denkfabriken
- Anwaltskanzleien
- Regierungsvertretungen